

### 6. Tire Repair Kit

#### A: NOTE

- Refer to the owner's manual for the tire puncture repair.
- Replace the expired sealant with a new part.
- The expiration date of a tire puncture repair sealant is shown on the label of the sealant bottle. The expired sealant is not included in the warranty.

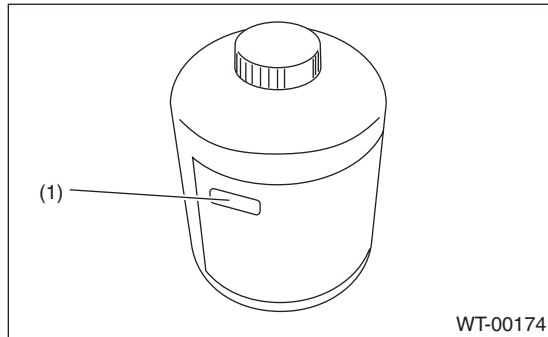

(1) Label

#### B: REPLACEMENT

##### 1. CLEARING THE TIRE PUNCTURE REPAIR SEALANT

###### CAUTION:

- Do not dispose the tire filled with repair sealant.
- Expired sealant, recovered sealant, or empty bottles and hoses of sealant used for repair work, contains ethylene glycol that is to be treated as industrial waste. Take appropriate measures to these materials at the time of disposal.
- Perform this operation in a well-ventilated space.
- During the operation, use appropriate protection tools to prevent the sealant from adhering to eyes, skin and clothes.
- After work, wash hands, face etc. well to wash away the sealant completely.
- If the sealant enters the mouth or eyes, wash it away with plenty of water, and consult a doctor.

1) Using a tire changer, remove the tire from the wheel.

###### NOTE:

Cover the tire changer and floor with cloth, and work while being careful not to spill the sealant.

2) Clear the sealant remaining inside the tire.

3) Wipe off the sealant adhered to the wheel, inside the tire, tire changer and on the floor with cloth carefully.

###### CAUTION:

- Completely wipe off the sealant in the mating surface of wheel rim and bead.
- Do not use the tire repaired with the tire puncture repair kit.
- Wheel can be reused even after repaired by using the tire puncture repair kit. Tire valve cannot be reused.

## 2. REPLACEMENT OF REPAIR SEALANT AND INJECTION CAP

### NOTE:

After using the repair kit for the repair work, replace the repair sealant and injection cap with new parts.

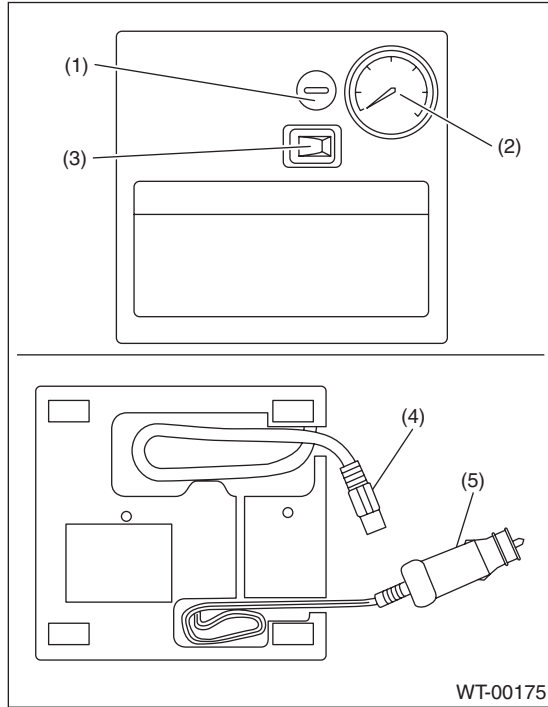

- (1) Air bleeding button
- (2) Pressure gauge
- (3) Power switch
- (4) Hose
- (5) Power cord

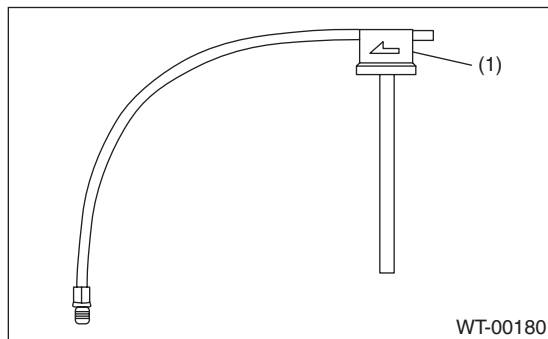

- (1) Injection cap

Place a new repair sealant bottle, injection cap and compressor back into the bag, and store the bag at the specified position of the vehicle.